



# USER MANUAL

## LIGHTWEIGHT PET UPRIGHT

UP04

USER MANUAL

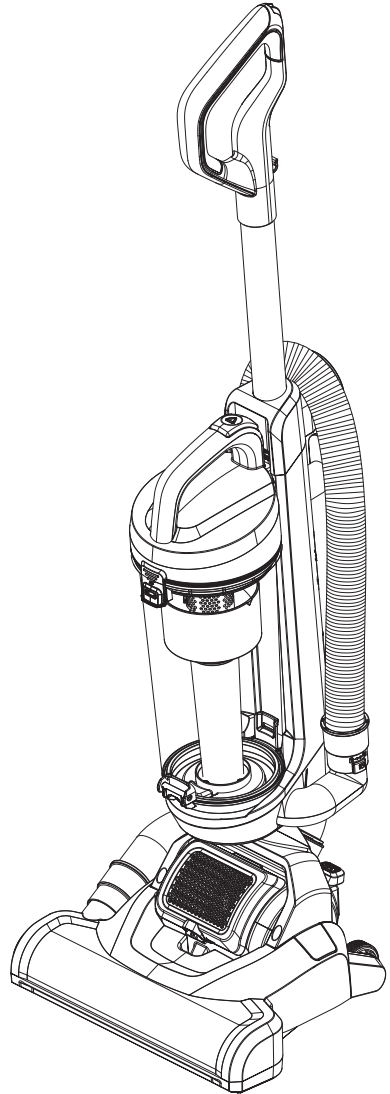

DIRTDEVIL.CO.UK

0333 400 0653

# WELCOME!

Congratulations on your purchase. Use this user manual to learn about your new vacuum's great features. Find out how to assemble, use and maintain your vacuum cleaner in this easy to follow manual.

## PLEASE READ CAREFULLY AND KEEP FOR FUTURE REFERENCE

If you have any questions, please email [info@dirtdevil.co.uk](mailto:info@dirtdevil.co.uk) to get in contact.

# CONTENTS

---

<b>Safety instructions</b> .....	<b>3</b>
<b>Getting to know your Dirt Devil vacuum cleaner</b> .....	<b>7</b>
<b>Assembling your vacuum cleaner</b> .....	<b>8</b>
<b>Using your vacuum cleaner</b> .....	<b>9</b>
<b>Maintaining your vacuum cleaner</b> .....	<b>11</b>
Removing and emptying the dust bin	
Checking for blockages	
Cleaning the filters	
Cleaning the brush roll	
Maintaining the brush roll	
Replacing the drive belt	
Changing the fuse	
<b>Troubleshooting</b> .....	<b>16</b>
<b>Specification</b> .....	<b>17</b>
<b>Parts list and contact details</b> .....	<b>20</b>

# IMPORTANT SAFETY INSTRUCTIONS

## FOR INDOOR USE ONLY

---

### **WARNING**

When using an electrical appliance, basic precautions should always be followed, including the following:

### **READ ALL INSTRUCTIONS BEFORE USING THIS APPLIANCE**

Failure to follow the warnings and instructions may result in electric shock, fire and/or serious injury.

### **TO REDUCE THE RISK OF FIRE, ELECTRIC SHOCK, OR INJURY:**

#### **USING THE VACUUM CLEANER**

- **DO NOT** use the vacuum cleaner outdoors. For household use only. Store indoors.
- **DO NOT** vacuum up hard or sharp objects such as glass, nails, screws or coins that could damage the vacuum cleaner.
- **DO NOT** vacuum liquids, use on wet surfaces or immerse in water as this could cause damage to the vacuum cleaner.
- **DO NOT** vacuum anything flammable, burning or smoking such as cigarette ends, matchsticks or ashes.
- **DO NOT** use the vacuum cleaner to clean your pets or any animal.
- Keep the vacuum cleaner moving over the carpet surface at all times to avoid damaging the carpet fibres.
- Keep the vacuum cleaner and accessories away from hot surfaces like hobs, cookers or microwave ovens.
- Always unplug the vacuum cleaner immediately if it malfunctions.
- **DO NOT** use this vacuum cleaner if it has been dropped, damaged, left outdoors, submerged in water or is not working as it should.
- **DO NOT** use the vacuum cleaner in an enclosed space filled with explosive, toxic or flammable vapours.

# IMPORTANT SAFETY INSTRUCTIONS

## FOR INDOOR USE ONLY

---

### PLUG AND CORD

- **DO NOT** use with a damaged cord or plug.
- **DO NOT** pick up or pull the vacuum cleaner by the cord.
- Take care that the cord is not kinked, pinched, pulled around sharp corners or run over.
- Ensure the cord does not come into contact with heat sources or become a trip hazard.
- When unplugging the vacuum cleaner from the wall socket, pull by the plug, not the cord, holding the socket with your other hand.

### AIRFLOW, FILTERS AND ATTACHMENTS

- **DO NOT** use without filters and bin in place.
- Always turn off and unplug the vacuum cleaner before changing filters or attachments.
- If when using, suction appears to be reduced, turn off and unplug the vacuum cleaner and clean all of the filters.
- **DO NOT** use if the airflow is restricted. If the air paths or the floor nozzle become blocked, turn off and unplug

the vacuum cleaner. Clear all obstructions before powering on again.

- Use genuine Dirt Devil filters and attachments only. Using non-genuine accessories may cause damage to the vacuum cleaner.
- When cleaning filters, ensure that they are completely dry and undamaged before replacing them back into the vacuum cleaner.

### PERSONAL SAFETY

- This machine is not intended to be used or cleaned by persons with reduced physical, sensory or mental capabilities, or lack of experience or knowledge, unless they have been given instructions concerning the machine by a person legally responsible for their safety. They should be supervised whilst using the machine. Children shall not use, clean or play with this machine, which when not in use should be secured out of their reach. Keep the vacuum cleaner out of reach of children.
- Packing material must not be used for playing. There is a danger of suffocation.

# IMPORTANT SAFETY INSTRUCTIONS

## FOR INDOOR USE ONLY

---

- Never leave the vacuum cleaner connected to the mains without supervision.
- Keep the floor nozzle away from hair, face, fingers, uncovered feet or loose clothing when the vacuum cleaner is working or plugged in.
- **DO NOT** use with wet hands.

### **USER MANUAL GUIDANCE**

- Keep this user manual in a safe place.
- Failure to comply with this user manual can lead to serious injuries or damage to the vacuum cleaner. We take no responsibility for damage due to failure to comply with this user manual.

### **AUTOMATIC THERMAL CUT OUT**

A safety thermostat inside the cleaner protects the motor from overheating if the airways or filters are clogged. If the appliance suddenly stops working during operation, switch off and unplug immediately. Allow the motor to cool for an hour, empty the dust bin and thoroughly clean the filters and airways. Plug in the vacuum again and switch on. The vacuum should now operate normally.

# WHAT TO EXPECT FROM YOUR USER MANUAL

Your user manual contains lots of handy information about your Dirt Devil appliance. Please have a read and keep it somewhere safe for future reference. Here's what you can expect from the different user manual sections.

## GETTING TO KNOW YOUR DIRT DEVIL APPLIANCE



The diagrams of your appliance on this page allow you to familiarise yourself with your machine. Doing so will make the information in the rest of the user manual clearer and help you to source the right replacement spare parts or accessories.

## ASSEMBLING YOUR APPLIANCE



When you first take your appliance out of its box, there will be some simple setup required to get it ready to use. The information in this section tells you the steps you need to take before using your new machine for the first time.

## USING YOUR APPLIANCE



It's important to use your machine correctly to avoid any damage to either the appliance itself or your floors. Get to know features, settings and the dos and don'ts of using your machine so it's cleaning to its maximum potential.

## MAINTAINING YOUR APPLIANCE



Every appliance needs a bit of routine maintenance from time to time. Learning how to recognise the different parts of your machine to maintain and how to look after them will enable your appliance to last longer.

## TROUBLESHOOTING



If you encounter any issues with your appliance, the troubleshooting section in this user manual is the first place you can turn. Here you will find information about potential problems as well as the solutions to resolve them.

## SPECIFICATION



If you want to know any of the specifics about your machine including model number, weight, capacity and input voltage, head over to the specification page in this user manual for a full list.

## PARTS LIST AND CONTACT DETAILS



Need a replacement part for your machine? The list on this page shows you all of the spare parts available for your model. You'll also find our full contact information here in case you need to get in touch for any reason.

# GETTING TO KNOW YOUR VACUUM CLEANER

## FEATURES

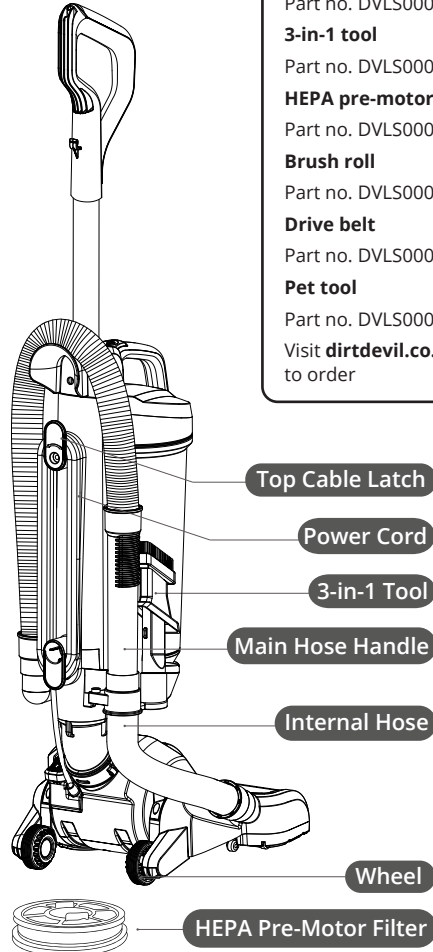
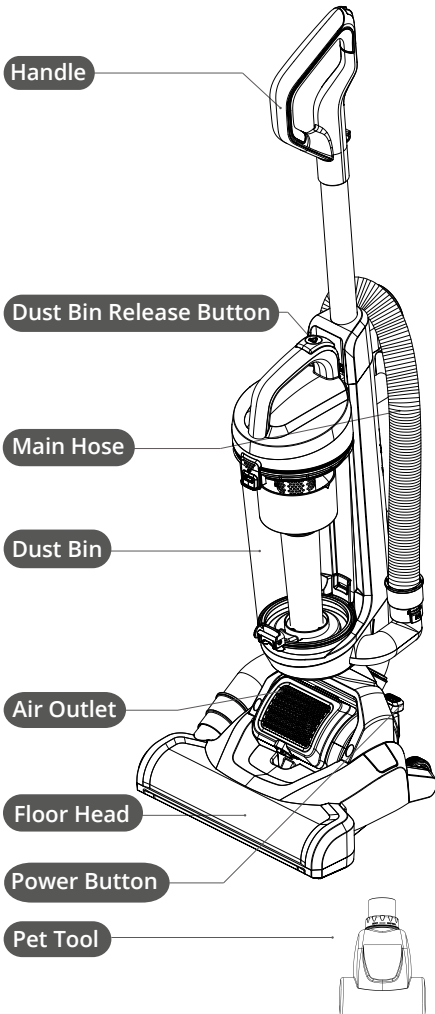

### SPARE PARTS

**Main hose**

Part no. DVLS00035

**3-in-1 tool**

Part no. DVLS00036

**HEPA pre-motor filter**

Part no. DVLS00041

**Brush roll**

Part no. DVLS00046

**Drive belt**

Part no. DVLS00032

**Pet tool**

Part no. DVLS00023

Visit [dirtdevil.co.uk](http://dirtdevil.co.uk) to order

# ASSEMBLING YOUR VACUUM CLEANER

## ASSEMBLING YOUR LIGHTWEIGHT PET UPRIGHT

Before assembling or disassembling attachments, ensure the upright vacuum is not plugged into the mains supply and is switched off.

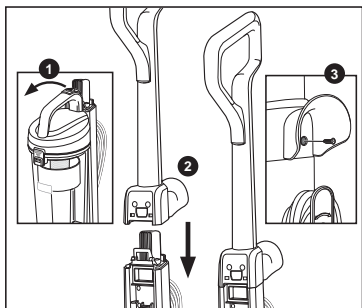

1. Remove the dust bin before installing handle. Push the handle onto the vacuum body, and use a Phillips screwdriver to secure it with the screw provided. **IMPORTANT:** The handle must be inserted first before replacing dust bin.

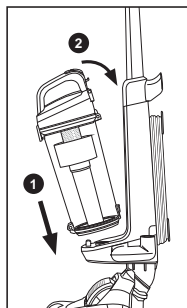

2. Place the dust bin back onto the machine and push until it clicks into place.

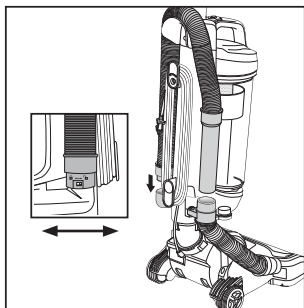

3. Place the short hose end onto the connector (left hand side if looking at the back of the vacuum), and rotate clockwise to lock.

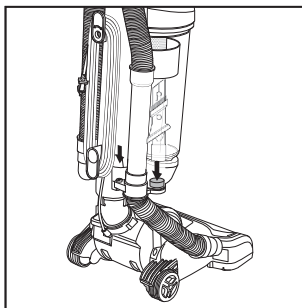

4. Push the main hose handle into the connector, and place the 3-in-1 tool onto the storage holder in front of the main hose handle.

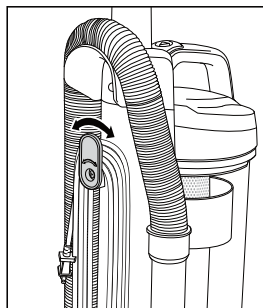

5. Twist the quick release cord hook to release the power cord.



# USING YOUR VACUUM CLEANER

## USING YOUR LIGHTWEIGHT PET UPRIGHT

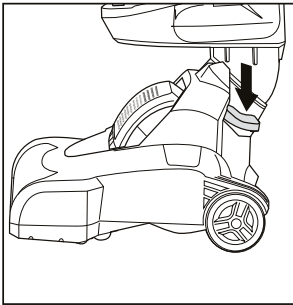

1. Plug in your machine and push power button to switch ON/OFF.

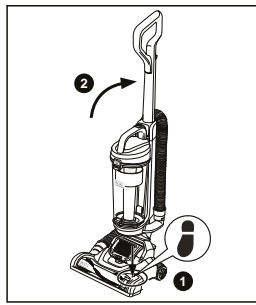

2. Step on the brush cover and pull back on handle, to engage for operation.

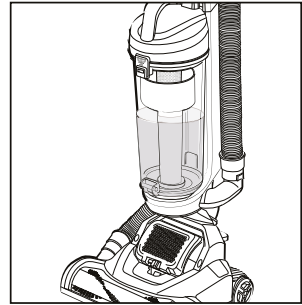

3. To maintain optimal performance, please empty dust bin when debris reaches MAX FILL line.

## USING THE ATTACHMENTS

When changing the attachments ensure the upright vacuum is switched off.

### 3-in-1 tool

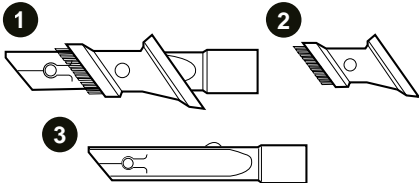

1. The 3-in-1 tool with brush allows for vacuuming in narrow and hard-to-reach places. Push the locking tab in to remove the brush accessory. Use the soft bristles for dusting surfaces, and reverse the attachment to use as an upholstery tool.

### Pet tool

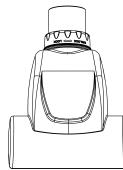

2. The pet tool gives floors and furniture a deeper clean in homes with pets. It is specifically designed to tackle areas heavily soiled with pet hair.

# USING YOUR VACUUM CLEANER

---

## USING THE ATTACHMENTS

1. Remove the main hose handle from the machine. Always ensure the vacuum is in upright (parked position) when using the main hose.
2. The rotating brush is lifted clear of the floor surface while the vacuum is parked upright. To prevent possible flooring damage, do not tilt the vacuum forwards or sideways while using the main hose.
3. For stairs, position the cleaner with the rear wheels against the stair tread (vacuum cleaner facing away from the stairs), and use the attachments to clean each step.
4. The main hose is ready to use alone, or fit the 3-in-1 tool or pet tool to suit the cleaning tasks.

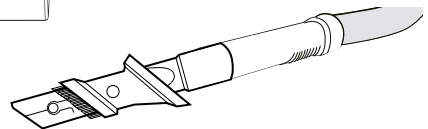
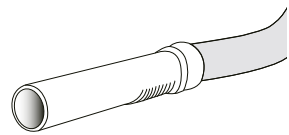
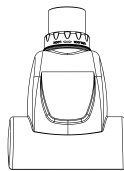
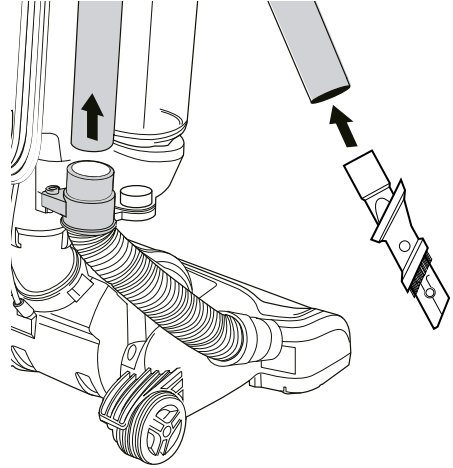

# MAINTAINING YOUR VACUUM CLEANER

## REMOVING AND EMPTYING THE DUST BIN

Ensure the vacuum is switched off before emptying the dust bin.

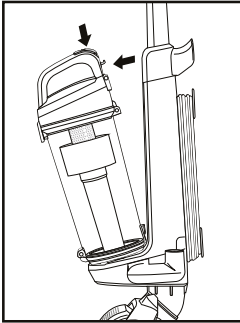

1. Press dust bin release button to remove the dust bin.

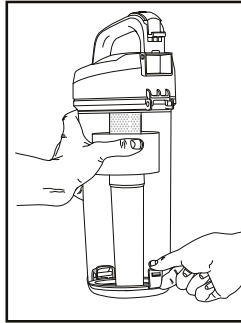

2. Hold dust bin over your rubbish bin and unclip the lock on the bottom of the bin, allowing the dust to empty.

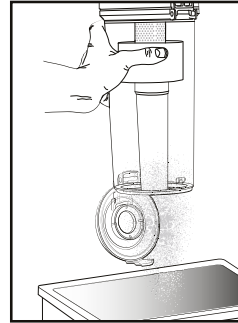

3. Close the base of the dust bin, align the bin's base back onto the machine and push until it clicks back into place.

### WARNING

If the filter or main hose is clogged, the motor may shut down in order to protect itself from overheating. If this occurs, unplug the vacuum, clean the filter and inspect the hoses and bin for clogging. Allow 1 hour for the unit to fully cool down before resuming use.

## CHECKING FOR BLOCKAGES

1. Inspect the lower tube and nozzle and remove any dirt and debris.
2. The internal hose can be removed from the nozzle if needed.
3. Remove the main hose by rotating the connector to unlock, and check for blockages in the hose and elbow connector.
4. Remove the dust bin, and follow the steps on the next page for cleaning.

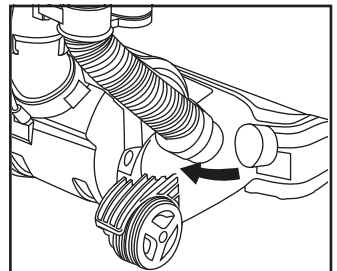

# MAINTAINING YOUR VACUUM CLEANER

## CLEANING THE FILTERS

Before starting any cleaning, ensure the upright vacuum is not plugged into the mains supply and is switched off.

Wash the filter with water every month. Allow at least 24 hours to dry and make sure it is thoroughly dry before re-inserting it into the appliance.

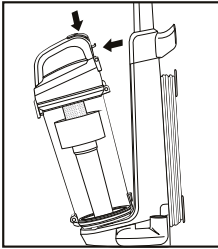

1. Remove the dust bin.

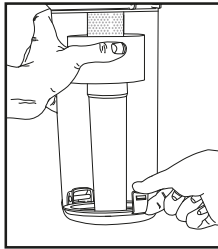

2. Push the release button, open the dust bin and clean all parts of the dust bin.

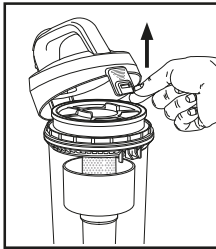

3. Open the dust bin filter lid located on top of the bin.

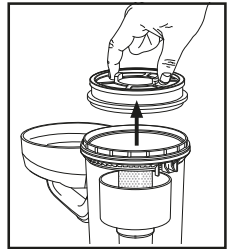

4. Remove the dust bin foam and HEPA pre-filter. Shake and tap the foam and HEPA pre-filter over a bin to remove any excess dust.

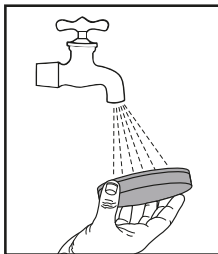

5. Use cold running water (no detergents) to wash both parts of the filter.



6. Allow filter to dry for 24 hours before putting back into the vacuum cleaner.

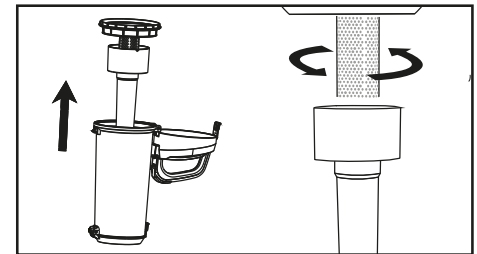

7. Lift out the assembly for the transparent dust bin, and then untwist the filter from the central tube to remove for cleaning dirt and debris as needed. Follow steps in reverse to reassemble.

# MAINTAINING YOUR VACUUM CLEANER

## CLEANING THE FILTERS

### WARNING

Turn off and unplug vacuum cleaner before performing maintenance to the vacuum cleaner.

- DO NOT** operate without filter installed
- DO NOT** wash dust bin in the dishwasher
- DO NOT** install filter if it is damp

### CAUTION

**DO NOT** turn the appliance on when the dust bin is removed. In order to keep the suction force optimised, the dust bin and filters must be cleaned regularly.

## CLEANING THE BRUSH ROLL

Carefully remove any string, hair or debris located on the brush roll. You can use a tool such as a small knife, seam ripper or scissors to remove and cut any hair or string.

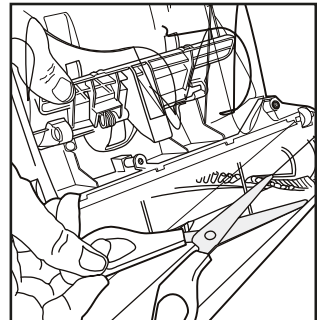

# MAINTAINING YOUR VACUUM CLEANER

## MAINTAINING THE BRUSH ROLL

You should check your cleaner's brush roll and drive belt regularly for wear or damage. You should also clean the brush and brush ends by removing string, hair and carpet fibres. These can wrap around the brush and hamper its ability to effectively clean your carpet. Also remove any debris that has accumulated under the brush cover.

1. Turn off the vacuum and unplug from the electrical socket.
2. Place the vacuum upside down with brush roll facing upwards.
3. Remove the six screws as shown with a small Phillips screwdriver (see figure 1).
4. Lift off brush cover (see figure 2). It will unclip from the securing lug on the front of the housing.
5. Grasp floor brush at both ends and remove by lifting out (see figure 3).
6. Clean string, hair and other debris from floor brush, motor pulley, and drive belt (see figure 4).
7. Check air passageway for obstructions. Remove debris from this area. When finished cleaning, reposition floor brush and drive belt. Turn floor brush by hand several times in the direction of the motor pulley. If properly installed, the drive belt will align itself on floor brush. Then replace the brush cover and re-install the six screws (see figure 5)

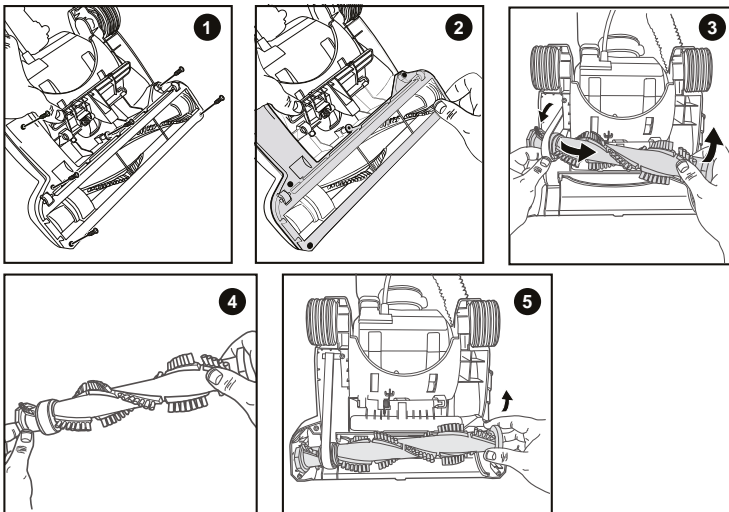

# MAINTAINING YOUR VACUUM CLEANER

## REPLACING THE DRIVE BELT

Make sure the vacuum is switched off and unplugged first. Check the drive belt carefully for wear, cuts and stressed areas. If the drive belt appears worn, you will need to replace it. To remove the drive belt, read the instructions and follow the drawings below:

1. Grasp the old drive belt and remove from motor shaft. Discard old drive belt.
2. Loop new drive belt over motor shaft and stretch other end over floor brush in the space provided between the bristles.
3. Place ends of floor brush down into slots on sides as shown. Turn floor brush by hand several times in the direction of the motor shaft. If properly installed, drive belt will align itself on floor brush.
4. Replace brush cover and six screws.

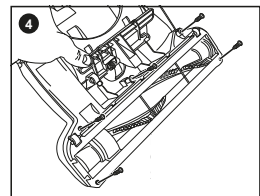
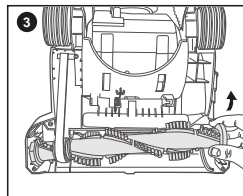
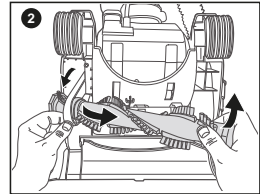
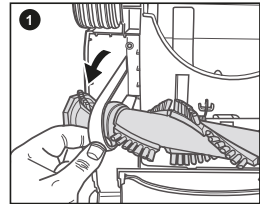

## CHANGING THE FUSE

1. Only use a 13 amp fuse.
2. To change the fuse, place a screwdriver into the recess of the plug cover and pull the fuse holder upward until it's free.
3. Slide the fuse out and pop in the replacement.
4. Slot the fuse holder back into the recess and push down until it locks into place.

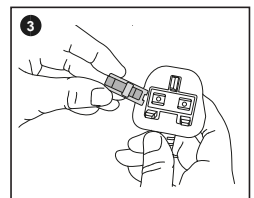
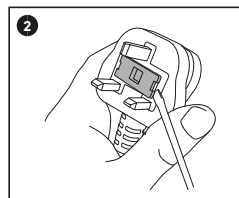

# TROUBLESHOOTING

---

## WARNING

To reduce the risk of shock and unintended operation, turn off power and unplug from the mains before servicing.

Problem	Solution
Low suction power	<ol style="list-style-type: none"><li>1.Empty the dust bin and clean the filters.</li><li>2.Check for blockages in the airpath: nozzle hose and connector, main hose, and the elbow connector between the hose and dust bin.</li><li>3.Remove any hair/threads from the brushroll, and check it is rotating correctly.</li></ol>
Vacuum is difficult to push on certain carpets	There is a flexible sealing strip on the floorhead behind the brushroll opening. Pinch one end to lift it slightly, and slide out of the floorhead sideways from one end to remove. This will make the cleaner easier to push over plush carpet.
Vacuum cleaner switches off during use	The thermal cutout has activated as the airflow is restricted. Unplug the vacuum, empty the dust bin, clean filters and check for blockages. Allow the motor to cool for 1 hour before resuming use.
Strange sound/smell	Switch off and unplug. Check that nothing has become caught in the brushroll in the floorhead. If the brushroll is jammed by an object or build up of hair or debris, this may damage the belt. Remove the cover and inspect the belt; replace if needed.

## CONTACT US

In any other case or if the solution explained above did not solve the problem, please contact us at [info@dirdevil.co.uk](mailto:info@dirdevil.co.uk)



# SPECIFICATION

---

Model	UP04
Power	400W
Capacity	3L
Weight	4.7kg
Main hose length	3m
Cord length	6.3m
Sound	78.5dB
Dimensions (LxWxH)	31 x 30 x 106cm
Filter type	HEPA
Input voltage	220-240V
Current	50Hz

**WARNING:** The above data has been supplied by the manufacturing plant and tested in laboratory conditions. The actual situation may vary according to the use environment. All product specifications are subject to change without notice.

## DISPOSAL

Waste electrical products should not be disposed of with household waste. Please recycle where facilities exist. Check with your local authority for recycling advice.

## UNBOXING

During transportation, packaging was used to protect the appliance against any damage. After unboxing, please dispose of all packaging in a way that will not cause damage to the environment.

IMPORTANT! During unboxing, keep the packaging materials (polyethylene bags, polystyrene pieces, etc.) out of reach of children.

### **This appliance complies with the following UK & European Directives:**

Electrical Equipment (Safety) Regulations 2016

Electromagnetic Compatibility Regulations 2016

Low Voltage Directive (LVD) 2014/35/EU

Electromagnetic Compatibility Directive (EMCD) 2014/30/EU









## SPARE PARTS



Replacement parts below are available for your appliance model.  
Please visit [dirtdevil.co.uk](http://dirtdevil.co.uk) to place your order.

### **Pet tool**

- Part no. DVLS00023

### **Drive belt**

- Part no. DVLS00032

### **Cord with plug**

- Part no. DVLS00034

### **Main hose**

- Part no. DVLS00035

### **3-in-1 tool**

- Part no. DVLS00036

### **Internal hose**

- Part no. DVLS00037

### **Dust bin**

- Part no. DVLS00038

### **Dust bin lid (bottom)**

- Part no. DVLS00039

### **Dust bin (top)**

- Part no. DVLS00040

### **HEPA pre-motor filter**

- Part no. DVLS00041

### **Cyclone**

- Part no. DVLS00042

### **Top cable latch with screw**

- Part no. DVLS00043

### **HEPA post-motor filter**

- Part no. DVLS00044

### **Motor filter cover**

- Part no. DVLS00045

### **Brush roll**

- Part no. DVLS00046

### **Wheel bar with clip**

- Part no. DVLS00047

### **Back wheels (pair)**

- Part no. DVLS00048

### **Base plate**

- Part no. DVLS00049

### **Handle with screw**

- Part no. DVLS00050

## VISIT DIRT DEVIL WEBSITE

[www.dirtdevil.co.uk](http://www.dirtdevil.co.uk)

## CONTACT US

0333 400 0653

[info@dirtdevil.co.uk](mailto:info@dirtdevil.co.uk)

Connect House,  
Small Heath Business Park, Talbot Way,  
Small Heath, Birmingham,  
B10 0HJ  
United Kingdom

**This appliance has a 1-year warranty as standard. To extend your warranty for 1 additional year, please visit [dirtdevil.co.uk](http://dirtdevil.co.uk) and register your appliance.**

Pictures are for illustration purposes only and may differ from the actual product. We are constantly striving to improve our products and the specifications contained herein are subject to change without notice. Made in China. DIRT DEVIL is a registered trademark of Techtronic Cordless GP and is used under licence by Connect Distribution Services Ltd.

Dirt Devil shall not be held liable for any damage caused by improper use of the product.